

# ParentView Self-Guided Tools

Registering with  
Student ID



**Step 1:**  
Download app\*, Register/Confirm your  
account, & Log-In



\*You can also access the app at [web.firstviewapp.com](http://web.firstviewapp.com)

# ParentView Self-Guided Tools

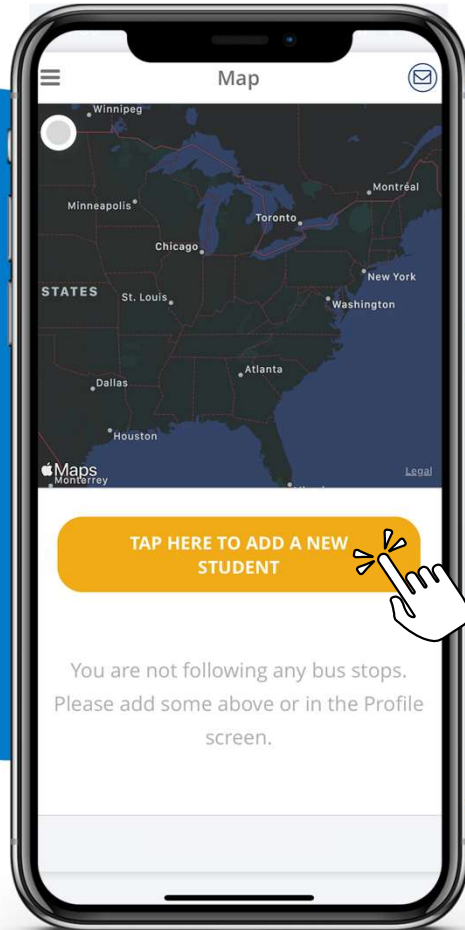

## Step 2:

Click the yellow message box to add your first student, or you can click profile and “Add a Student” in the app menu



# ParentView Self-Guided Tools

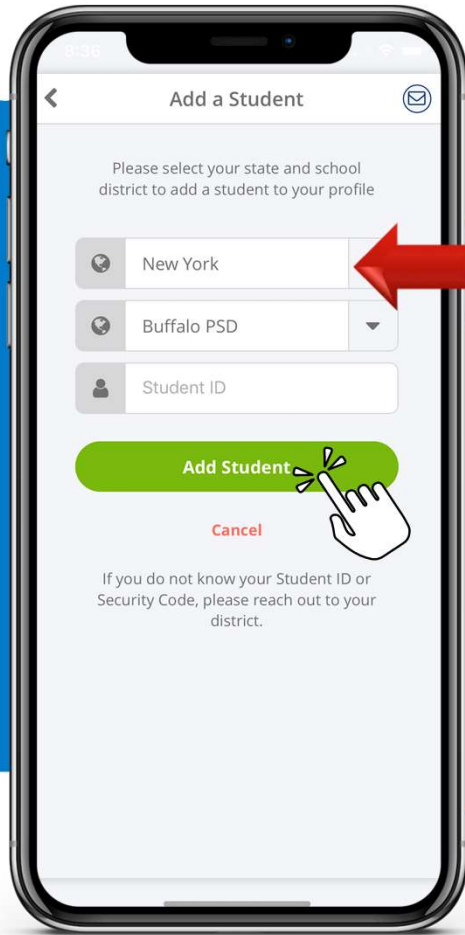

## Step 3:

- Select your state and school district from the drop down
- Add your Student ID\*
- Click 'Add Student'



\*Additional codes may be required. If you do not know the codes needed to access the app, please contact your school district.

# ParentView Self-Guided Tools

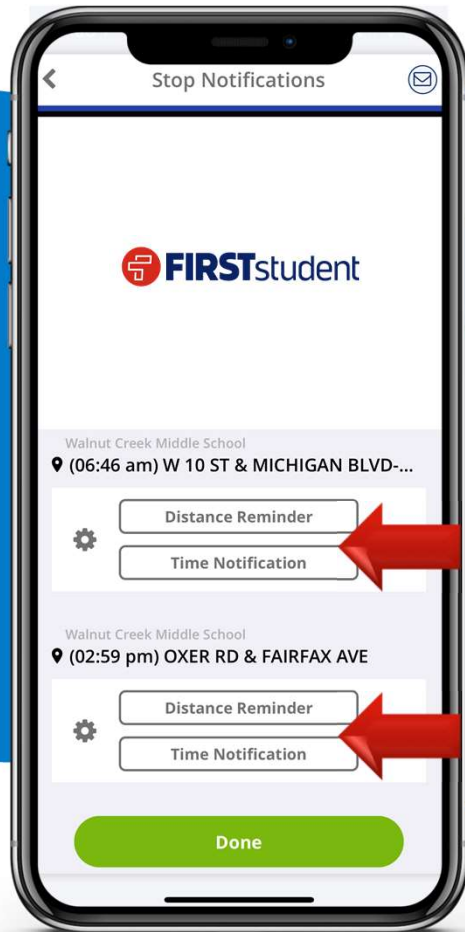

## Setting Up Alerts

Setup optional alerts for your student's routes. These can be added from the profile section and selecting your student's name under 'Student Stops'



# ParentView Self-Guided Tools

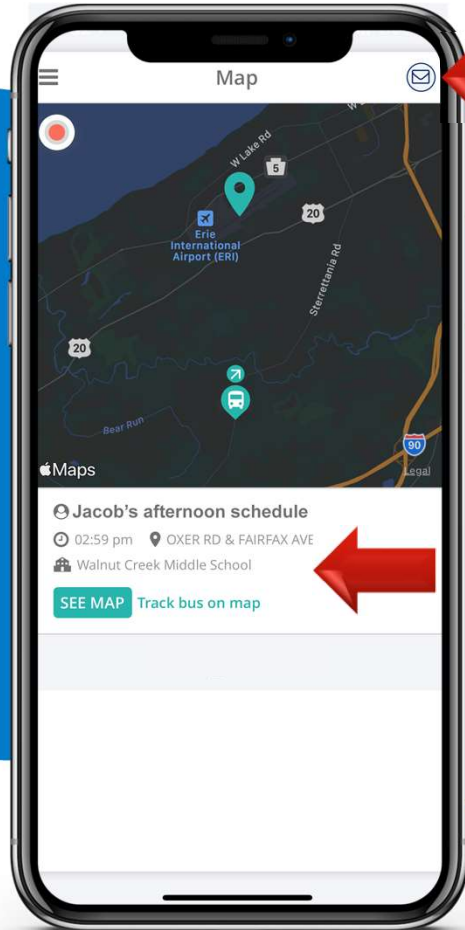

## Your student is added!

- Your student's stop information is now displayed on the map for tracking
- Click the envelope to contact Customer Support

